

Lot Charges

| | Resident | Non-Resident |
|------------------------------------|----------|--------------|
| Blocks 119-122, 128,160-194 | \$650 | \$780 |
| Blocks 138-141, 150-151, 200 | \$1,100 | \$1,320 |
| Blocks 202-204, 208-212 | \$1,600 | \$1,900 |
| Blocks 152-153, 207, 213 | \$2,300 | \$2,760 |
| Block 154 | \$3,450 | \$4,140 |
| Baby section | \$100 | \$120 |

Price is per grave space and includes perpetual care. See map, page 3.

Columbariums

| | Resident | Non-Resident |
|---|----------|--------------|
| Blocks 33, 66, 118, 206 | \$1,200 | \$1,440 |
| Block 190 | \$600 | \$720 |
| Honor Garden (veterans/spouses only)..... | \$500 | \$600 |

Scattering Garden Inscriptions

| | |
|---------------------------|-------|
| Inscription, 2 lines..... | \$375 |
| Additional line | \$160 |
| Final date cut | \$180 |

Columbarium Memorial Wall Inscriptions

| | |
|---------------------------|-------|
| Inscription, 1 line | \$240 |
| Additional line | \$120 |
| Final date cut | \$140 |

Pre-Paid Charges

Greenwood allows prepayments on the following charges:

| | |
|---|-------|
| Grave opening, Casket | \$700 |
| Grave opening, Cremation (in-ground or niche)..... | \$350 |
| Final Date Cut on Marker (not raised letters) | \$220 |

Pre-paid grave opening charges are for weekday, non-holiday interments made between 10 a.m. and 3:30 p.m. The cemetery will not accept pre-paid charges for Saturday or holiday grave openings.

Foundation Charges

| | | | | | |
|-------------|-------|-------------|-------|-------------|-------|
| 20x10 | \$84 | 36x12 | \$181 | 54x16 | \$362 |
| 24x12 | \$120 | 42x14 | \$246 | 60x16 | \$403 |
| 30x12 | \$150 | 48x14 | \$282 | 66x18 | \$498 |

Contact the office for larger sizes. Anyone wishing to install foundations in the cemetery must pay a location fee (\$100 for 48" or shorter, \$250 for 49" or longer) for cemetery personnel to locate the correct placement for the foundation. Form and payment must be submitted prior to installation. Greenwood Cemetery does not require a border around the marker.

Price list as of March 27, 2025

Interment (Burial) Charges

No Sunday burials

Service Hours:

- 10 am-3:30 pm for all processions from church or funeral home and graveside cremation services
- 11 am-3:30 pm for graveside casket services

Adult (37-inch vault and above)

| | |
|---------------------|---------|
| Monday-Friday | \$700 |
| Saturday | \$1,000 |
| Holiday* | \$1,200 |

Cremations (cremation burial vault required)

| | |
|---------------------|-------|
| Monday-Friday | \$350 |
| Saturday | \$600 |
| Holiday* | \$700 |

Winter Processions

| | |
|-------------------------------|-------|
| Above all other charges | \$350 |
|-------------------------------|-------|

Not applicable if mourners are not present

Directional Signs

By request, the cemetery may provide directional signs for scheduled funerals. If you are doing your own service or scattering on a Saturday or holiday, we will place signs for a fee of \$250.

Late Charges

Add \$75 per half hour for procession entering the cemetery after 3:30 p.m. or for services starting at 3:30 p.m. or later

Grave Setup Charges

| | |
|------------------|-------|
| Tent | \$200 |
| Chairs (8)..... | \$50 |
| Chairs (12)..... | \$100 |

Cremation or memorial services only.

Not in lieu of vault company tent

Infant (Up to 36-inch Vault)

| | |
|---------------------------|-------|
| Monday-Friday | \$100 |
| Saturday or holiday | \$250 |

Disinterment (Normal re-interment charges will apply)

| | |
|-----------------|-------|
| Adult..... | \$850 |
| Infant..... | \$230 |
| Cremation | \$350 |

Payments are due two (2) full business days prior to scheduled interment. A 3.5% administration fee will be applied if paying by debit or credit card(s).

*Holidays

New Year's Day, Memorial Day, Independence Day, Labor Day, Thanksgiving, Friday after Thanksgiving, Christmas Eve, Christmas Day

Burial Vaults Full Size and Cremations

Cemetery regulations require the use of an approved burial vault for all interments including cremations. Some examples of approved cremation vaults are Crowne Regent, Batesville Peblecove, or Wilbert Universal Urn/Vault. Call us at 231-347-6531 if you wish to use some other vault. The top of the cremation vault must be 100 square inches or larger.

Burial Authorization Form

Cemetery regulations require a signed Burial Authorization Form before opening a grave.

- This form must be signed by the lot owner, an heir of the lot owner, or someone designated in writing by one of the above with the authority to give authorization for burial.
- When it is impossible for a visit to the Cemetery Office, authorization must be given by mail, email, or fax within the designated time. (Authorization by phone is not acceptable)
- The Burial Authorization Form must be signed and in our possession a minimum of two (2) working days prior to the scheduled burial.
- Payment in full must be received two (2) working days prior to the scheduled burial. This may be paid by credit card, cash or check or may be guaranteed by the attending Funeral Director and delivered prior to the interment.
- The "On-Time Deposit," if applicable, must be paid two (2) working days prior to the scheduled burial. It will be returned if the mourners assemble for the ceremony within 10 minutes of the scheduled time.

Winter Burials

Burials will be made throughout the winter except on Sundays or when weather conditions make the interment process unsafe. Burials are made in the winter at the discretion of the Superintendent. A procession during the winter will be \$350 above the normal charges. A "procession" includes one or more persons other than funeral home personnel.

Baby Section

Only flush markers are allowed. Greenwood Cemetery will supply one temporary grave marker which remains the property of the cemetery. Family may plant flowers only, no shrubbery.



History Books

Most years, Greenwood Cemetery offers various tours of the grounds and rich history of the people of Petoskey who have come before us and have helped to make it what it is today.

These stories are written and designed in a thermal-bound book. You may get a copy at our office as they are available. Follow us on social media or sign up for our newsletter at www.gwood.us to stay in the loop on future tours and other events.

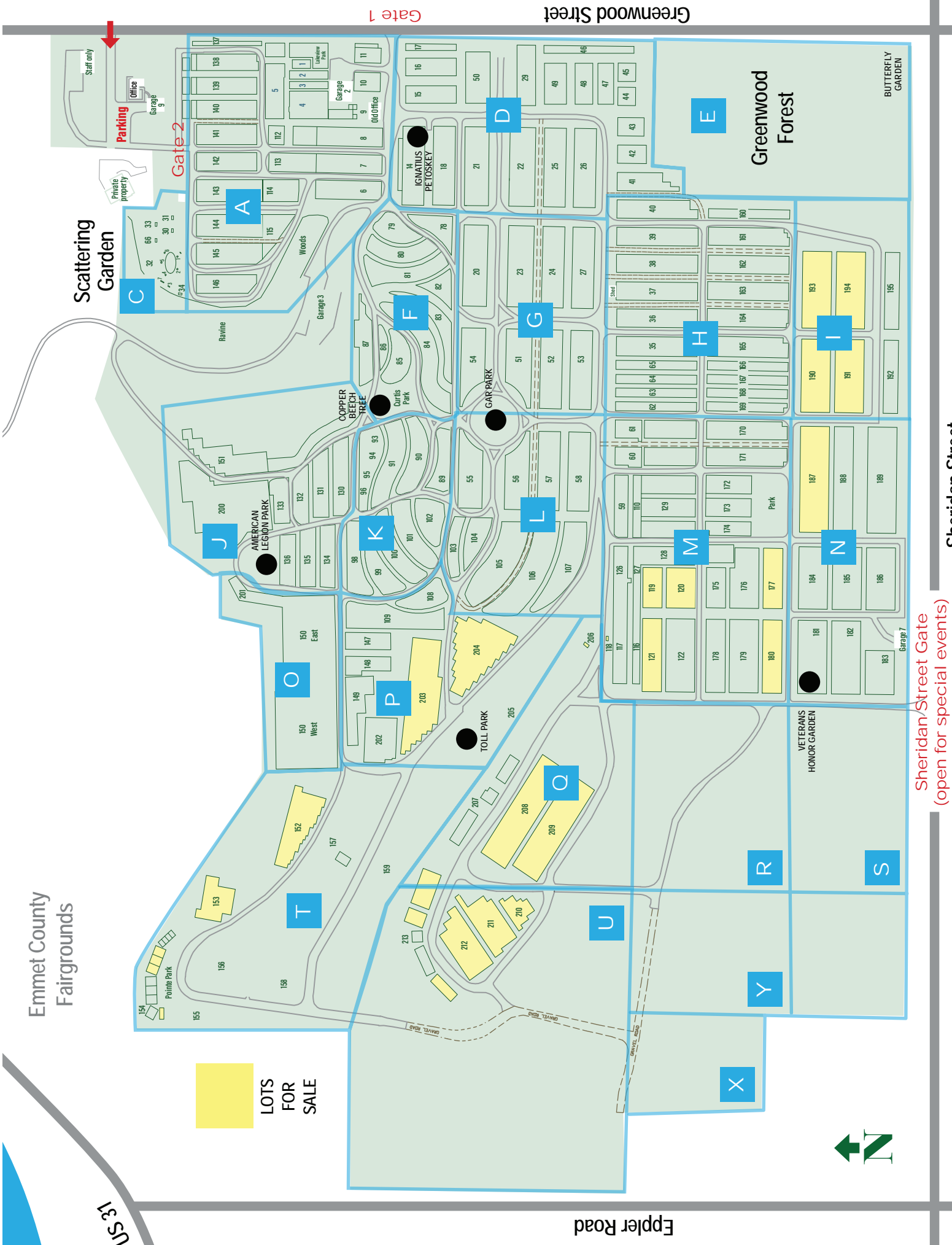

LOTS FOR SALE



Emmet County Fairgrounds

US 31

Eppler Road

Sheridan Street Gate
(open for special events)

Sheridan Street

Greenwood Street

Gate 1

Gate 2

Greenwood Forest

BUTTERFLY GARDEN

Scattering Garden

Parking

Office

Garage 3

Staff only

Private property

Garage 3

Garage 2

Garage 1

Garage 3

Garage 3

Garage 3

Garage 3

Garage 3

Garage 3

Garage 3

Garage 3

Garage 3

Garage 3

Garage 3

Garage 3

Garage 3

Garage 3